

# M3 UL10

The Most Ultra and Powerful Mobile Computer



## Physical Characteristics

DIMENSION (W x H x D)	73 x 209 x 36,3 mm
	2,8 x 8,2 x 1,4 in
WEIGHT	623 g / 22 oz. (with battery)
DISPLAY	3,5" VGA Blanview LCD 480 x 640 pixels
	3,5" QVGA Blanview LCD 240 x 320 pixels
BATTERY	Standard Li-Polymer 3,7 V 4,500mA
	Type Smart Battery

## Performance Characteristics

PROCESSOR	CPU 833 MHz (Cortex-A8)
OS	Windows CE 6,0
MEMORY	RAM 256 MB
	ROM 1 GB
	Card Slot Micro SD (up to 32 GB)
INTERFACE	Host 1,1 / Client 2,0 (Full Speed)

## User Environment

TEMPERATURE	Operating - 20 to 60°C / - 4 to 140°F
	Storing - 30 to 80°C / - 22 to 176°F
HUMIDITY	95 % non-condensing
TUMBLE TEST	2,000 1,6 ft. / 0,5 m tumbles (4,000 drops)
DROP TEST	1,8 m / 6,6 ft.
IP RATING	IP65

## Wireless Radio Options

WLAN	IEEE 802,11 a/b/g
SECURITY	WEP, WPA, WPA2, TKIP, AES, EAP-FAST, EAP-TLS, EAP-TTLS, PEAP-GTC, PEAP-TLS, PEAP-MSCHAPv2, LEAP, CCXv4
BLUETOOTH	Class II, v2,0 with EDR

## General Options

SCANNER	1D Laser, 2D Imager, Long Range
CAMERA	3,0 M Pixels Auto Focus Camera
KEYPAD	37 key
	55 key

\* The contents of this brochure were written based on the "current state" of the product, and the details are subject to change without prior notice.

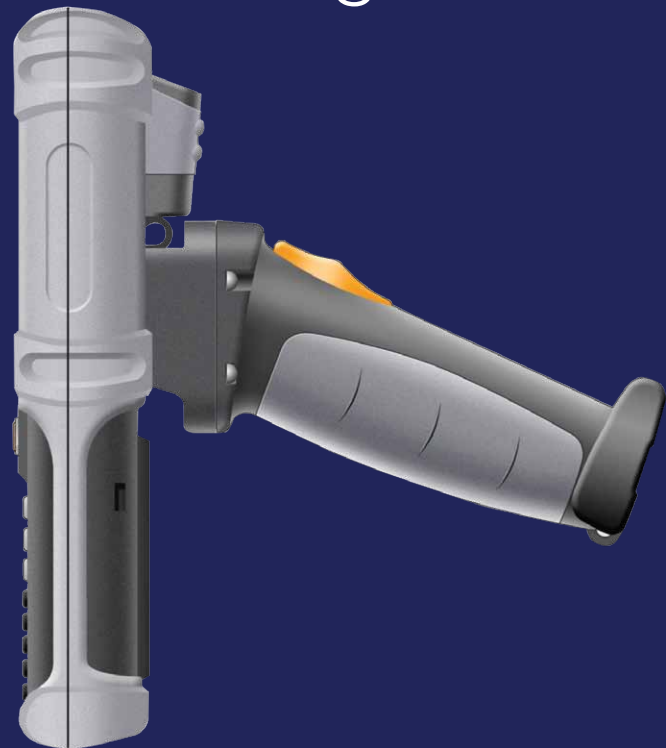

# ***M3*** ***UL10*** Design View