

Product 513292



513292 Active holder for fixed installation. With tilt swivel, with Molex adapter system. 2A charger.

An active holder which is to be connected inside the dashboard, this gives a discreet, neat installation without cables hanging over the interior!

You can choose to use the holder as an active holder for charging of your device only, or to connect an adapter to the Molex connector for additional features. Then you can use the holder also for power supply of a GPS receiver or other own solutions (can not be used for data communication or audio connection).

12/24 Volt. The product is E-approved. Connect the power cable with a 2 A fuse. 2 A charger. Professional installation recommended. The holder is attached onto a tilt swivel so you can easily adjust your device in order to avoid light reflection. Attach onto a ProClip Mounting Platform.

EAN: 7320285132924

Item no 513292 fits:

Honeywell Dolphin 6000 (For all countries)

INSTALLATION INSTRUCTIONS

1.



2.

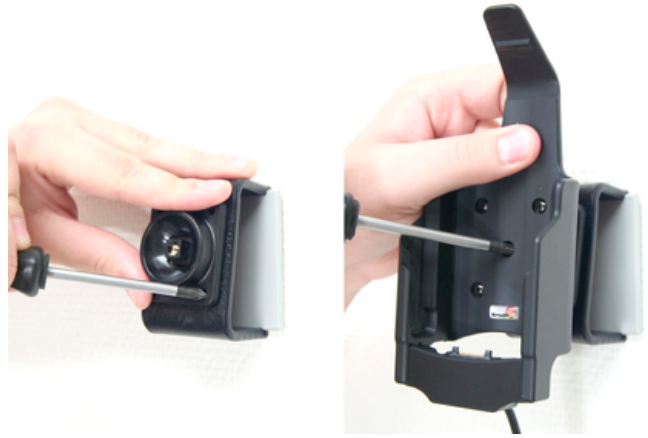

3.



4.



Please read all of the instructions and look at the pictures before attaching the holder. Important Note: Route the cable from the holder into the vehicle dashboard and route the power cable from the charger unit to the power supply source in the vehicle and connect as follows: 1. Connect the White wire to a Negative Ground connection of the vehicle or the vehicle chassis. 2. Connect the Red wire to a 12/24 Volt power supply in the vehicle that is controlled by the ignition switch of the vehicle.

1. Loosen the screw in the center of the holder so you can remove the tilt swivel attaching plate on the back.

2. Place the attaching plate onto the desired position. Screw the attaching plate into place with the enclosed screws. Place the holder over the attaching plate so the screw fits in the hole in the tilt swivel. Tighten the screw until the holder is firmly in place, but still can be adjusted.

3. To place the device in the holder: Place the bottom part of the device into the holder. Slide the device downward into place in the holder. To remove the device from the holder: Open the latch on the holder. Then the device is set free, lift it upward out of the holder.

4. The holder is in place.